



## Bungalow in San Pedro del Pinatar

€149,900



1



1



51m<sup>2</sup>



53m<sup>2</sup>



Modern Apartments with comunal Pool Near the Beach in San Pedro del Pinatar&#13;&#13;Exclusive New Build Apartments on the Costa Calida&#13;&#13;Discover this boutique development of 12 modern apartments designed to offer comfort, functionality and quality of life in one of the most attractive areas of the Costa Calida. Located close to Lo Pagan in San Pedro del Pinatar, this residential...(Ask for More Details!)



PLANTA	USO	SUP. ÚTIL	SUP. CONST.
Baja	Vivienda	36.45 m <sup>2</sup>	43.00 m <sup>2</sup>
	Porche	7.50 m <sup>2</sup>	7.50 m <sup>2</sup>
	Terraza	44.25 m <sup>2</sup>	51.40 m <sup>2</sup>

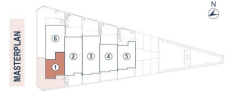

\*Este documento es orientativo. El promotor se reserva el derecho a introducir modificaciones por razones técnicas e legales. (This document is illustrative. The promoter reserves the right to introduce modifications due to technical and legal reasons.)

## Los apartamentos / Apartments

MASTERPLAN  
PLANTA BAJA  
/ MASTERPLAN  
GROUND FLOOR

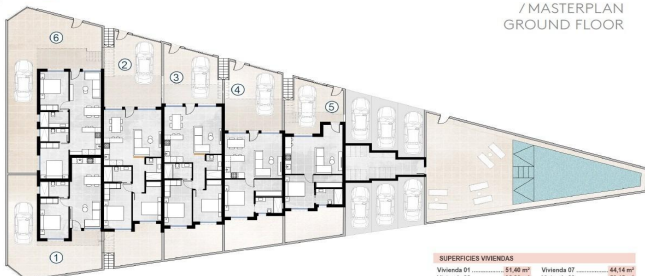

SUPERFICIES VIVIENDAS	
Vivienda 01	51.40 m <sup>2</sup>
Vivienda 02	52.20 m <sup>2</sup>
Vivienda 03	53.30 m <sup>2</sup>
Vivienda 04	55.74 m <sup>2</sup>
Vivienda 05	55.20 m <sup>2</sup>
Vivienda 06	79.56 m <sup>2</sup>
Vivienda 07	44.14 m <sup>2</sup>
Vivienda 08	59.45 m <sup>2</sup>
Vivienda 09	74.50 m <sup>2</sup>
Vivienda 10	74.20 m <sup>2</sup>
Vivienda 11	54.44 m <sup>2</sup>
Vivienda 12	55.11 m <sup>2</sup>

\*Este documento es orientativo. El promotor se reserva el derecho a introducir modificaciones por razones técnicas e legales. (This document is illustrative. The promoter reserves the right to introduce modifications due to technical and legal reasons.)